



**SWEETWATER, NOLAN COUNTY, TEXAS**

**MARKET:**

A new monopole billboard completed in 2013 for westbound traffic from the heart of Sweetwater along Business Loop I-20. Lighted for 24-hour exposure!

**LOCATION:**

400' West of Poplar St - Sweetwater

**HIGHWAY:**

Bus Loop I-20

**ORIENTATION:**

Side of Pavement - South  
For Traffic - Westbound

**FACE:**

Position - Cross Read  
Size - 10' H x 24' W  
Illuminated - Yes

**TERM:**

12, 24 & 36 Months

**GPS:**

Latitude: 32.4641  
Longitude: -100.4211

**WEEKLY IMPRESSIONS:**

25,700

**PANEL ID:**

TNO-11B

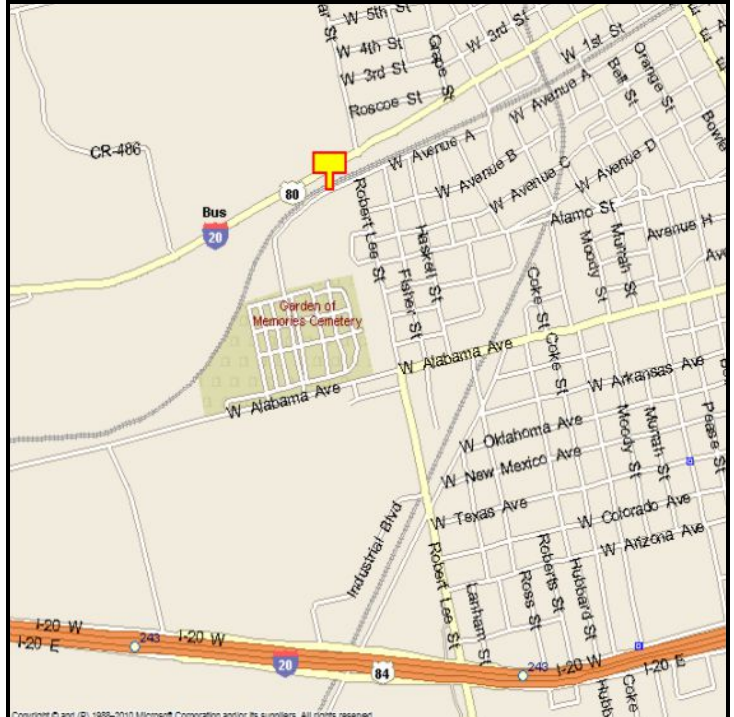

For More Information, Please Call

877.583.3801

E-mail - [sales@lookoutdoor.biz](mailto:sales@lookoutdoor.biz)